

# THE ST ALBANS

5 BEDROOM HOME



Opening onto a spacious hallway flanked on either side by a home office/reception room and a good sized living area, the ground floor of the St Albans is completed by a modern kitchen/diner with bi-fold doors to the exterior, a comfortable snug and a convenient utility room and WC.

To the first floor is a large family bathroom, storage cupboard, one single bedroom, two double bedrooms, a double bedroom with ensuite and a primary bedroom with ensuite and dressing room.



## GROUND FLOOR

Kitchen / Dining / Snug  
10.7 x 4.7m

Utility  
3.1 x 1.8m

WC  
1.8 x 1.5m

Study / Reception Room  
3.5 x 3.5m

Lounge  
5.5 x 3.7m

Store 1  
1.2 x 1.2m

Store 2  
0.9 x 0.8m

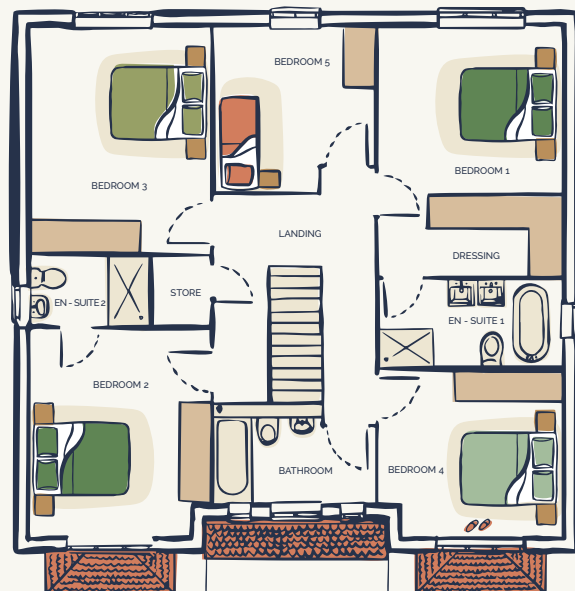

## FIRST FLOOR

Primary Bedroom  
3.6 x 3.3m  
En - Suite 1  
3.6 x 1.7m  
Dressing  
3.6 x 1.5m

Bathroom  
3.2 x 1.7m  
Store  
1.2 x 1.2m

Bedroom 2  
4.1 x 3.6m  
En - Suite 2  
2.3 x 1.4m

Bedroom 3  
4.5 x 3.6m

Bedroom 4  
3.6 x 3.3m

Bedroom 5  
3.3 x 3.2m

This information is for guidance only. Illustrations show a typical floor plan however there may be variances depending on the development and specific home. A detailed drawing pack is provided at the beginning of the reservation process.